

The Holiday Package Rush

How Can You Prepare Now?



If your property doesn't have a solution to the package problem yet, try out these quick tips to help you with this year's holiday package rush.

Then, learn how Luxer One can get you through next year completely free of the package management headache!

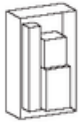

Delivery to Units First

Require parcel carriers to attempt delivery to units before delivering to your office.



Encourage Faster Pickup

Ask residents to pick up their packages from your office within 24 hours.



Seasonal Help

Hire a temporary employee to help manage packages.

How Can Luxer One's Lockers Help with the Holidays?



Automated Overflow Solution

If all standard size lockers are full, Luxer One's Oversized Locker or Luxer Room can:

- Take in overflow packages regardless of size.
- Accept extra-large packages.



Fees for Faster Pickup

Luxer One can introduce temporary holding fees to encourage residents to pick up packages quickly.



Support Team

Residents and carriers can contact us 24/7 for package support, easing the strain on your property's team.



Surveillance

All Luxer One systems come with video surveillance & access logs for accountability & security, especially useful during high traffic periods like the holidays.